

# Compression Lugs

## Two Hole - Long Barrel

### Features

- Produced from high conductivity copper tubing and suitable for heavy duty applications
- Tin-plated to provide corrosion resistance
- Color coded

### Applications

- Listed for 35 KV maximum when properly installed
- Ideal for direct burial in earth or concrete and grounding applications

### Standard Material

- Copper

### Standard Finish

- Tin plated

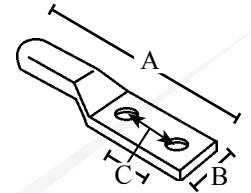

Catalog Number	UPC	Wire Size	Color Code	Bolt Size	Unit Carton	Ship Case	Weight/Case	Inches		C = Hole Spacing
								A	B	
<b>3201</b>	81812	<b>#8</b>	Red	<b>1/4"</b>	100	1000	20	2.24	.42	.625
<b>3202</b>	81633	<b>#6</b>	Blue	<b>1/4"</b>	100	1000	21	2.24	.42	.625
<b>3203</b>	81635	<b>#4</b>	Gray	<b>1/4"</b>	100	1000	21	2.36	.49	.625
<b>3205</b>	81636	<b>#2</b>	Brown	<b>5/16"</b>	50	500	29	2.87	.50	.75
<b>3206</b>	81638	<b>1/0</b>	Pink	<b>3/8"</b>	25	250	30	4.40	.74	1.75
<b>3207</b>	81639	<b>2/0</b>	Black	<b>3/8"</b>	25	250	25	4.61	.81	1.75
<b>3208</b>	81701	<b>3/0</b>	Orange	<b>1/2"</b>	20	200	19	4.69	.90	1.75
<b>3209</b>	81641	<b>4/0</b>	Purple	<b>1/2"</b>	10	100	19	4.72	1.00	1.75
<b>3209A</b>	81642	<b>250 MCM</b>	Yellow	<b>1/2"</b>	10	100	27	4.95	1.09	1.75
<b>3209B</b>	81643	<b>300 MCM</b>	White	<b>1/2"</b>	10	100	29	5.31	1.19	1.75
<b>3210</b>	81644	<b>350 MCM</b>	Red	<b>1/2"</b>	10	100	37	5.39	1.28	1.75
<b>3210A</b>	81645	<b>400 MCM</b>	Blue	<b>1/2"</b>	5	50	39	5.47	1.39	1.75
<b>3211</b>	81646	<b>500 MCM</b>	Brown	<b>1/2"</b>	5	50	32	5.79	1.72	1.75
<b>3211A</b>	81647	<b>600 MCM</b>	Green	<b>1/2"</b>	5	50	41	5.79	1.72	1.75
<b>3212</b>	81648	<b>750 MCM</b>	Black	<b>1/2"</b>	5	50	43	6.30	1.90	1.75