

# Rigid Floor Flange Plates

## Malleable Iron

### Features

- Topaz floor flanges provide a solid means of support for 1/2" through 2" threaded pipes
- Ideal for hanging security cameras, smoke detectors, fire alarms, signals/strobes and other low-voltage and electronic signaling devices from ceiling
- These floor flanges may also be used in a variety of other applications as required
- Four holes for mounting to a flat surface

### Applications

- Use to connect threaded Rigid or IMC conduits to flat surfaces
- The threaded hub allows pipes to be screwed in and securely fastened

### Standard Material

- Malleable iron

### Standard Finish

- Zinc plated



E195124

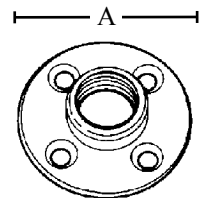

Catalog Number	UPC	Size	Ship Case	Weight/Case	A
<b>291</b>	12420	<b>1/2"</b>	50	23	3.000
<b>292</b>	12430	<b>3/4"</b>	50	25	3.375
<b>293</b>	12440	<b>1"</b>	50	43	3.625
<b>294</b>	12450	<b>1-1/4"</b>	25	20	4.000
<b>295</b>	12460	<b>1-1/2"</b>	25	32	4.375
<b>296</b>	12470	<b>2"</b>	25	27	4.875