

# Compression Lugs

## One Hole - Short Barrel



### Features

- Ideal for direct burial in earth or concrete and grounding applications
- Produced from high conductivity copper tubing and suitable for heavy duty applications
- Tin-plated to provide corrosion resistance
- Color coded

### Applications

- Listed for 35 KV maximum when properly installed

### Standard Material

- Copper

### Standard Finish

- Tin plated

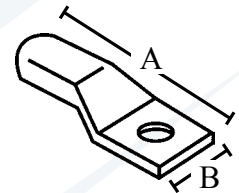

Catalog Number	UPC	Wire Size	Color Code	Bolt Size	Unit Carton	Ship Case	Weight/Case	Inches	
								A	B
<b>2901</b>	81614	<b>#8</b>	Red	<b>10</b>	100	1000	14	1.20	.42
<b>2901A</b>	81615	<b>#8</b>	Red	<b>1/4"</b>	100	1000	13	1.20	.42
<b>2902</b>	81616	<b>#6</b>	Blue	<b>1/4"</b>	100	1000	17	1.50	.42
<b>2902A</b>	81617	<b>#6</b>	Blue	<b>5/16"</b>	100	1000	18	1.50	.42
<b>2903</b>	81618	<b>#4</b>	Gray	<b>1/4"</b>	100	1000	20	1.50	.71
<b>2903A</b>	81619	<b>#4</b>	Gray	<b>5/16"</b>	100	1000	18	1.50	.71
<b>2903B</b>	81620	<b>#4</b>	Gray	<b>3/8"</b>	100	1000	19	1.50	.71
<b>2905</b>	81621	<b>#2</b>	Brown	<b>3/8"</b>	100	1000	24	1.80	.83
<b>2905A</b>	81622	<b>#1</b>	Green	<b>3/8"</b>	100	1000	31	1.83	.67
<b>2906</b>	81623	<b>1/0</b>	Pink	<b>3/8"</b>	50	500	24	1.83	.74
<b>2907</b>	81624	<b>2/0</b>	Black	<b>3/8"</b>	50	500	34	2.24	.81
<b>2907A</b>	81625	<b>2/0</b>	Black	<b>1/2"</b>	50	500	27	2.24	.81
<b>2908</b>	81626	<b>3/0</b>	Orange	<b>3/8"</b>	25	250	33	2.36	.90
<b>2909</b>	81627	<b>4/0</b>	Purple	<b>1/2"</b>	25	250	27	2.36	1.00
<b>2909A</b>	81804	<b>250 MCM</b>	Yellow	<b>1/2"</b>	25	250	27	2.48	1.09
<b>2909B</b>	81805	<b>300 MCM</b>	White	<b>1/2"</b>	25	250	27	2.49	1.19
<b>2910</b>	81628	<b>350 MCM</b>	Red	<b>1/2"</b>	20	200	36	2.61	1.28
<b>2910A</b>	81629	<b>400 MCM</b>	Blue	<b>1/2"</b>	10	100	26	3.95	1.39
<b>2911</b>	81606	<b>500 MCM</b>	Brown	<b>5/8"</b>	10	100	26	3.28	1.54
<b>2911A</b>	81807	<b>600 MCM</b>	Green	<b>5/8"</b>	5	50	26	3.50	1.72
<b>2912</b>	81630	<b>750 MCM</b>	Black	<b>5/8"</b>	5	50	26	4.37	1.90